

ALU COMPACT

Customised to Perfection.

TECHNICAL INFORMATION

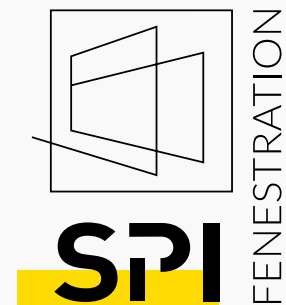



ALU COMPACT

Customized to Perfection.

Alu Compact

Alu Compact our premium model.

The aluminum thermal broken system with slim design combines high thermal performances with sleek aesthetic features.

Alu Compacts minimal look, similar to steel, can offer a reasonable alternative especially with it's available in two different designs: *Retrò* and *Classic* to fit in all architectural designs.



mod. **Retrò**

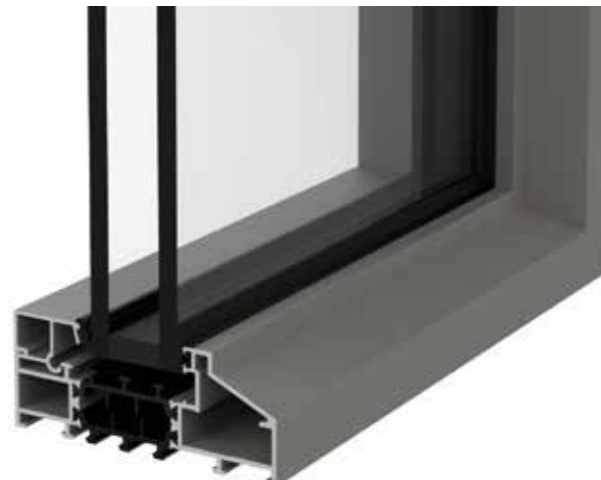

mod. **Classic**

The slim aluminium window by SPI

Technical Standard Features

- Selective low E - Argon filled glasses
- Warm edge
- Concealed hardware with 180° opening
- Tilt-and-turn opening
- Lever bar on secondary sash
- Third concealed hinge on semi-fixed sash
- Safety stop mechanism
- EPDM sealing gasket

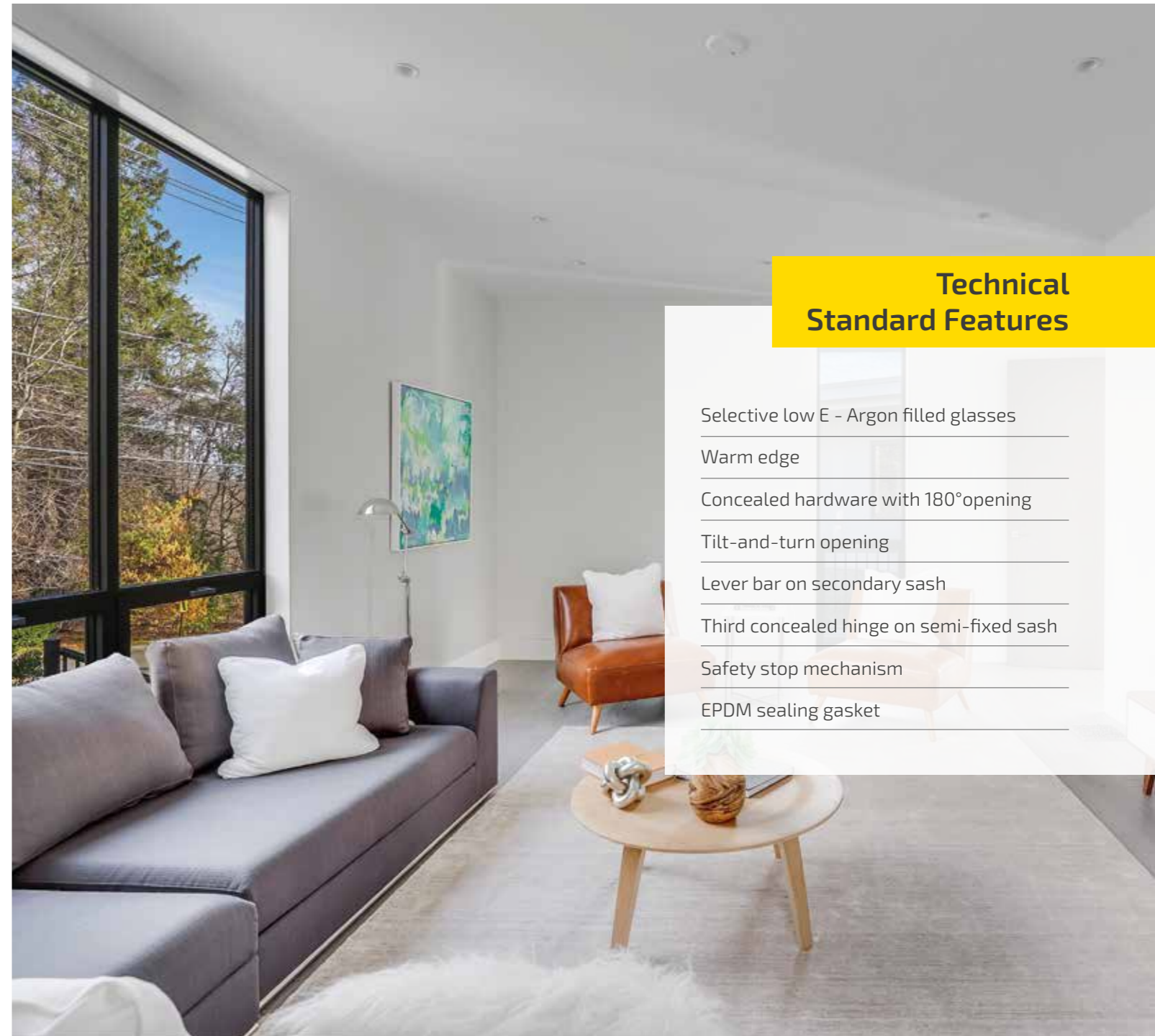

Alu Compact

Accessories

Glass

As a standard feature, **Alu Compact** is equipped with argon filled dual glazing and warm edge technology. The standard glass cavity is 1 3/16", with the option to choose 1 7/16" or 1 9/16" dual or triple glazed IG.

Glazing options include combinations of tempered, acoustic, laminated and sun protection IG's, giving us the ability to achieve up to .025 SHGC.

Accessories

The accessories are available in white, silver or black. For a more modern design, we offer the square shaped Toulon model by Hoppe.



Locking/Thumb turn

On request, we can install a thumb turn lock and/or cylinder with a unified key.

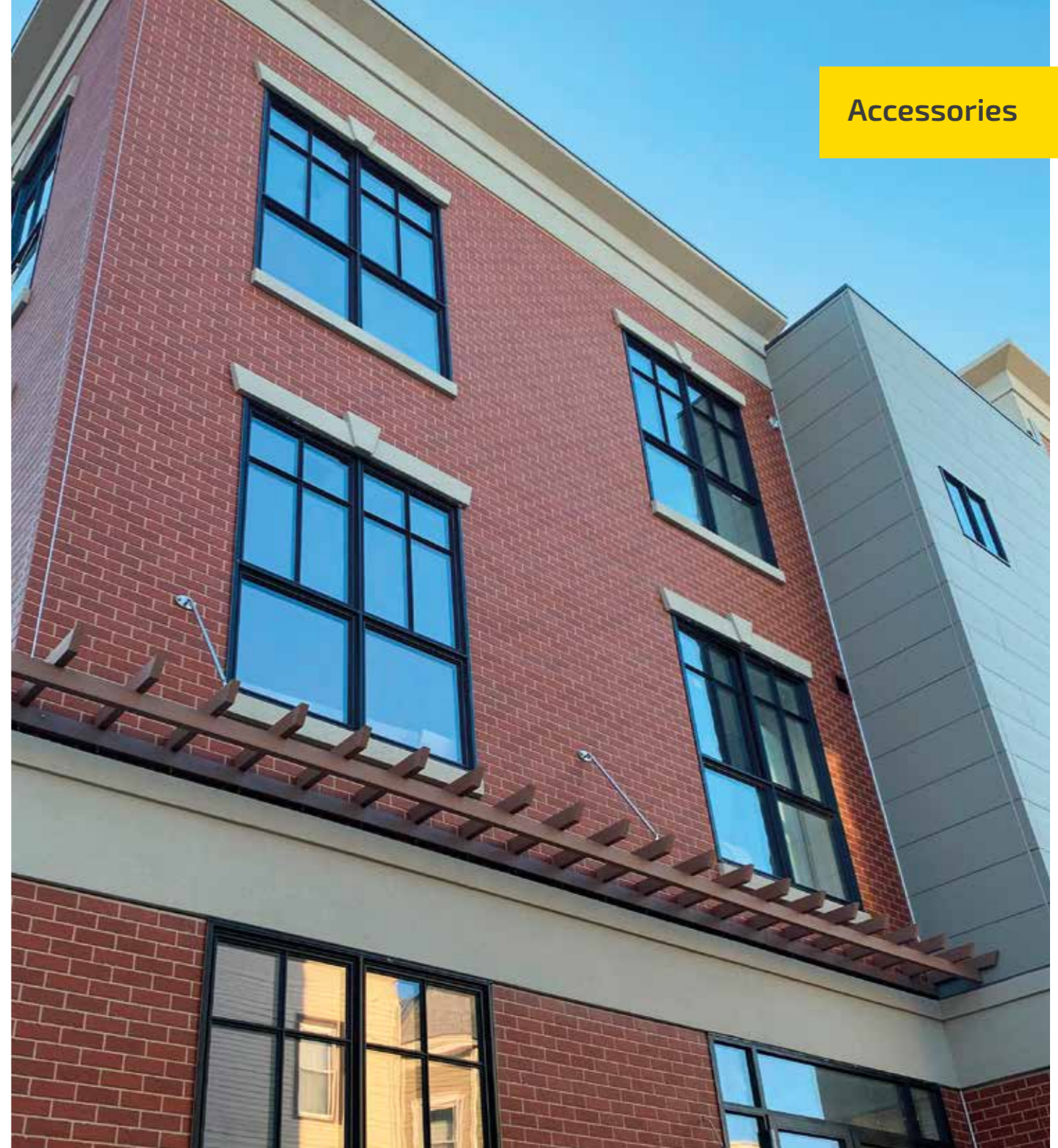

Hinges

Concealed hinges with an opening at 180 is standard for all **Alu Compact** casement windows and frenchdoor typologies. However, if requested visible hinges can be installed. For doors with a lock, outward opening, hoppers or awning style, concealed hinges are not available.

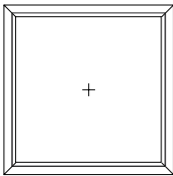

Alu Compact

Below are the available typologies and recommended sizes for our **Alu Compact** line.

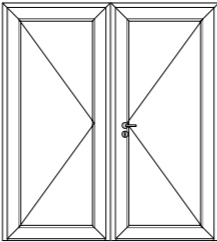
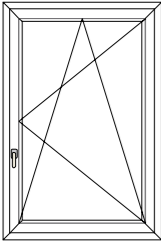
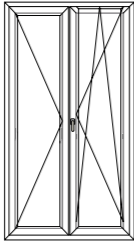
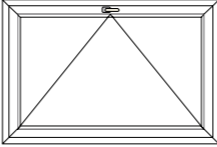
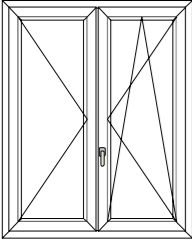
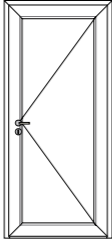
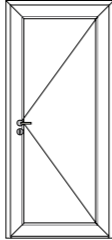
 <p>Fix max recommended size per single panel 5' 10 7/8" W x 7' 10 1/2" H</p>	 <p>Inward tilt/turn frenchdoor single sash max recommended size 2' 7 1/2" W x 7' 10 1/2" H</p>	 <p>Inward door with lock double sash max recommended size 7' 10 1/2" W x 8' 6 3/8" H</p>
 <p>Inward tilt/turn window single sash max recommended size 3' 3 3/8" W x 6' 6 3/4" H</p>	 <p>Inward tilt/turn frenchdoor double sash max recommended size 5' 3" W x 7' 10 1/2" H</p>	 <p>Inward awning window max recommended size 5' 10 7/8" W x 3' 11 1/4" H</p>
 <p>Inward tilt/turn window double sash max recommended size 6' 6 3/4" W x 6' 6 3/4" H</p>	 <p>Inward door with lock single sash max recommended size 3' 11 1/4" W x 8' 6 3/8" H</p>	 <p>Door outward opening max recommended size 3' 11 1/4" W x 8' 6 3/8" H</p>

The recommended sizes are intended to provide a general indication of feasibility, the max dimensions may vary based on the installed glass and other variables to be verified by SPI technical office.
Curved shape windows available on request for Alu Compact Retrò only. Not available for Alu Compac Classic version.

Available opening typologies

Available opening typologies



Alu Compact Retrò

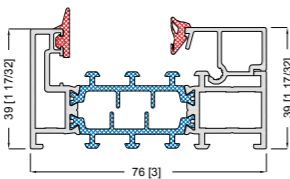

Retrò Fix

Casement window – Retrò design

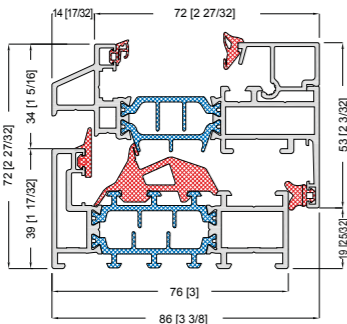

Casement window Retrò design - interlock

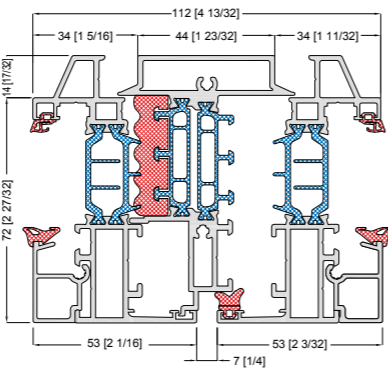

Alu Compact Classic

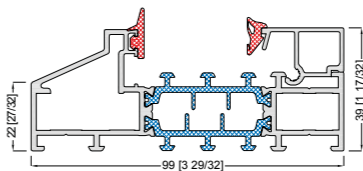

Classic Fix

Casement window – Classic design

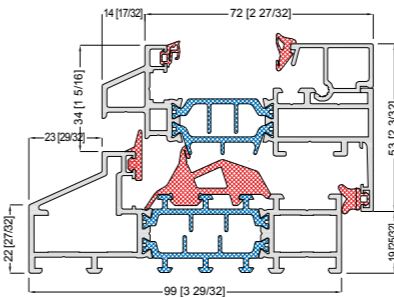

Casement window Retrò & Classic design - interlock

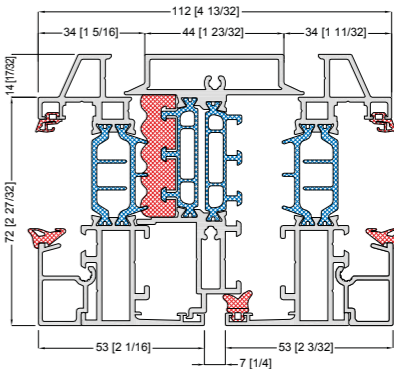

Entrance Door

Profile used when
the lock is required.

Light version
with drop sill

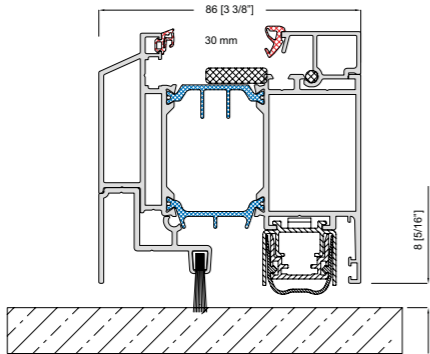

Available for
Retrò & Classic

Pro
version

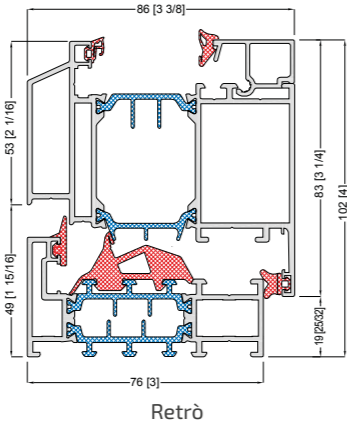

Retrò

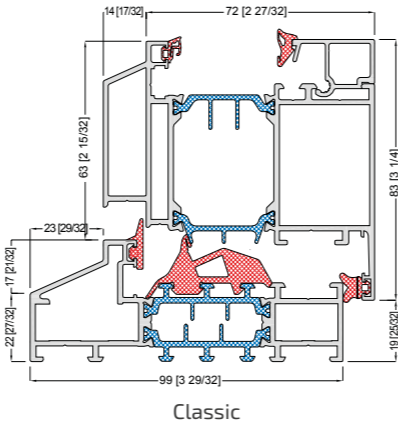

Classic

Low
threshold

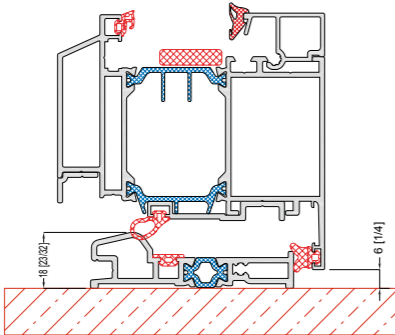

Available for
Retrò & Classic

Technical sections

SDL & TDL

Simulated Divided Lite
True Divided Lite

TDL for sash

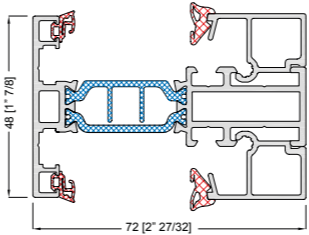

TDL for frame

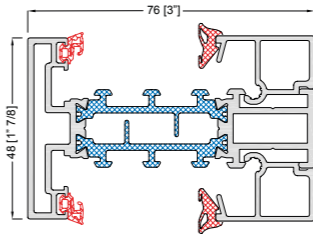

SDL Standard

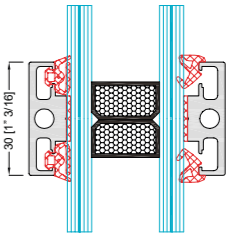

Alu Compact
Retrò

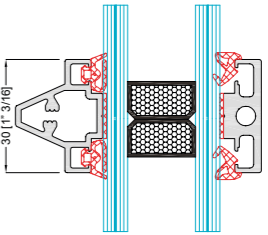
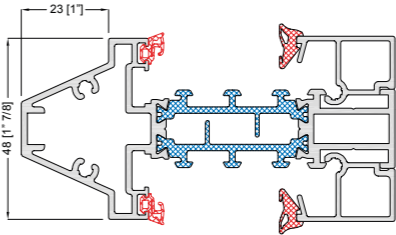
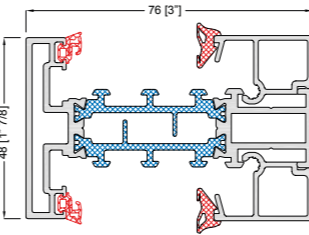

Alu Compact
Classic

SDL Slim

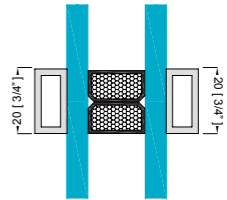

On request for
Alu Compact
Retrò & Classic

Alu Compact

We offer **Alu Compact** in a vast selection of gloss or matte finish powder coated colors. Specialty colors or anodized finishes are also available upon request. Here are a few samples of our most popular colors.

Two-toned color windows are subject to a minimum order.

			
RAL 9010 White Matt	RAL 1013 Ivory Matt	RAL 7001 Grey Matt	RAL 6005 Green Matt
			
RAL 8017 Brown Matt	RAL 9005 Black Matt	RAL 7016 Grey Matt	RAL 8019 Grey Brown Matt
			
Corten	Iron Grey	Bronze	Silver
			
Steel			

SPI Finestre is able to offer its customers the QUALICOAT SEASIDE coating available by standard for all aluminum windows line. This special treatment for aluminum profile can improve the durability of the goods, even in areas near to the sea.



Main features of QUALICOAT SEASIDE treatment (standard on SPI windows)

Mild-aggressive environments (Area 2):
 Seaside A (surplus etching, 2grams/m²)
 Coastal area between 1km & 10km
 Proximity to railways
 Local strong pollution like estuaries of large rivers, cattle farms, Airports,etc.
 Treatment + Finish:
 Degreasing & etching =2g/m²
 Conversion layer to ensure adhesion
 Finish layer of minimum 60µ

On request, we can provide a special treatment for extra durability: the Seaside PA coating.

Aggressive environments (Area 1):
 Seaside PA (pré-anodization)
 Coastal area up till 1 km inland
 Swimming pool environments
 Industrial sites with strong onsite pollution within 1km radius
 Treatment + Finish:
 Degreasing & etching >2g/m²
 3µ-8µ anodizing layer, ensures adhesion and corrosion resistance
 Finish of minimum 60µ

AAMA & NFRC Certificates

Alu Compact is certified with the NFRC label and AAMA for the US market. The tilt turn windows, inswing doors, lift & slide, outswing doors and fix windows are officially certified by National Fenestration Rating Council.



AAMA tests air permeability, resistance to wind load and watertightness of windows. In the US these tests are particularly strict, and they are carried out through meticulous methods in order for the market to issue strongly weather resistant windows projected to stand up against extreme climate conditions, tropical storms and seasonal hurricanes.



This certification helps you compare among energy-efficient windows by providing you with energy performance ratings in multiple categories. In particular the NFRC label provides independent ratings in these categories: U-Factor, Visible Transmittance, Solar Heat Gain Coefficient, and Air Leakage.



KEYSTONE CERTIFICATIONS, INC.
145 LIMEKILN RD, SUITE 100B
NEW CUMBERLAND, PA 17070
PHONE: 717-932-8500

Notice of Product Certification Authorization National Fenestration Rating Council

Issued To: Manufacturer: SPI S.P.A. Address: Zona Industriale SNC Maierato, Vibo Valentia, 89843 Italy Man'f Code SPS Cert Date: 2/3/2020	Certification Number
	11281
	Product Line Number
	SPS - K - 001
	Revision Date
	2/3/2020

The Following NFRC Product Line Has Been Authorized For Certification:

Model / Series: Alu Compact Tilt Turn Window
Operator Type: DATT
Frame Type: AT
Sash Type: AT
Exp. Date: 12/4/2023

Ratings Authorized For Certification:

Rating	Property	Authorized
NFRC 100	U-factor	<input checked="" type="checkbox"/>
NFRC 200	Solar Heat Gain Coefficient	<input checked="" type="checkbox"/>
NFRC 200	Visible Light	<input checked="" type="checkbox"/>
NFRC 400	Air Leakage	<input type="checkbox"/>
NFRC 500	Condensation Resistance	<input checked="" type="checkbox"/>

Fenestration products are not NFRC Certified unless manufactured and labeled in accordance with the current version of NFRC-700, Product Certification Program requirements.

*This is a cover sheet for an NFRC Certification Authorization Report (CAR)
the corresponding CAR may be downloaded for printing at www.nfrc.org.
The manufacturer is authorized to label the options listed in the corresponding CAR.
Please notify Keystone of any errors or omissions within 10 days of receipt.*

Due diligence was used in authorizing these products for certification. By accepting this report the licensee agrees to hold harmless and indemnify Keystone Certifications, Inc. from all claims or liabilities which may arise based on this certification authorization. Certification authorization is based on NFRC program requirements and simulation and test reports from accredited laboratories.

Nailing Fins & Brackets

To simplify the installation process, we can pre-install nailing fins. Nailing fins help secure the window to the wall, holding it in place while the shims and screws are being installed. The fins come in a raw aluminum, unpainted profile. We can match color coat it on request.

As an alternative, SPI can provide fixing brackets for when an indirect fixing is required.

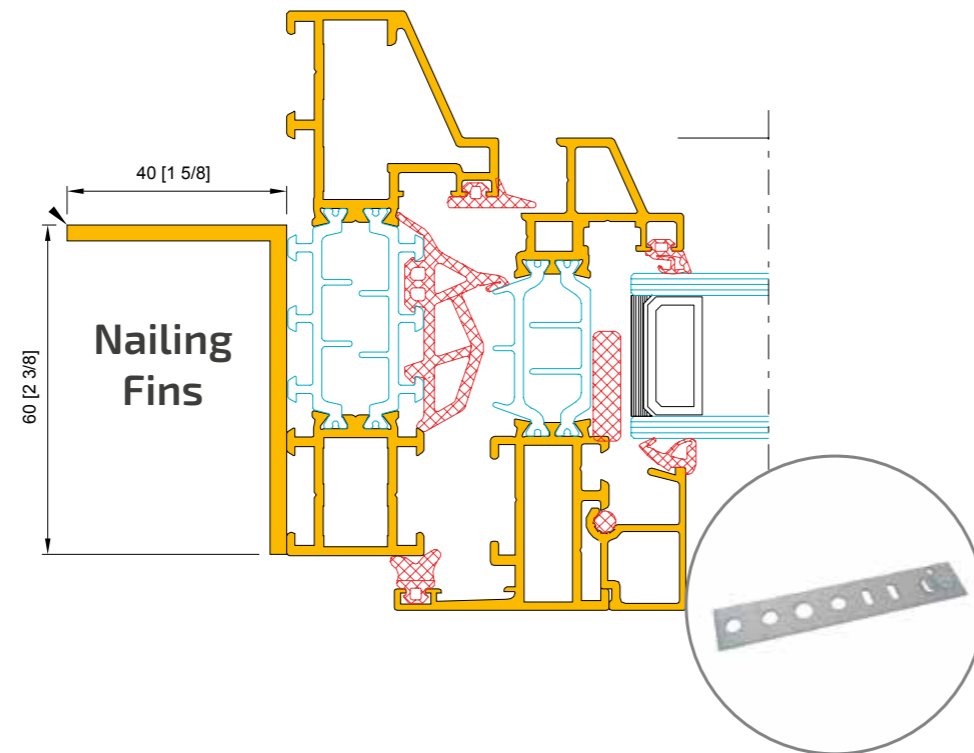

Opening limiters

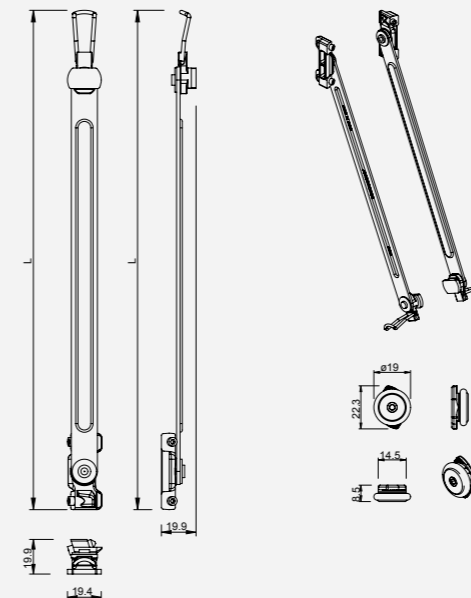

On request, we can provide opening limiters for casement windows in Alu Compact series. This accessory permit an opening up to 90°.

Available pre-installed or loose.

Visio 130

Visio 130 is a high insulated lift and slide system, which meets the highest requirements with regard to insulation, stability and safety.

Visio 130 is available with various opening possibilities and the low threshold offers a solution to improve the building's accessibility.

A special corner solution makes it possible to open up spaces without any fixed corner element, creating a perfect and clear continuity between the indoor and outdoor spaces.

Also available is the **Visio 130 Essential**, which has a mere 50mm meeting section.



Low threshold



High threshold



Flush threshold

The slim lift and slide by SPI

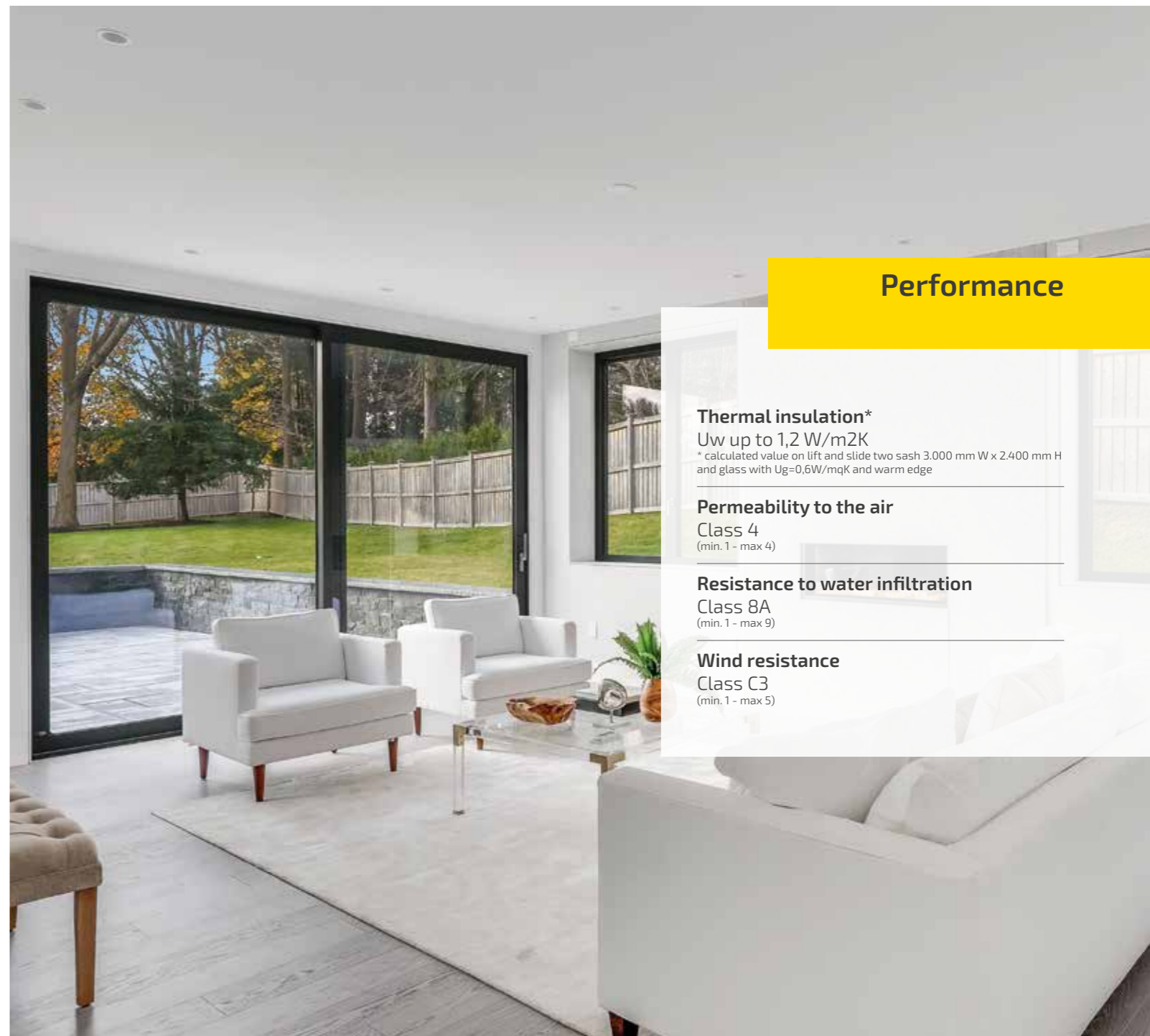

Performance

Thermal insulation*

Uw up to 1,2 W/m²K

* calculated value on lift and slide two sash 3.000 mm W x 2.400 mm H and glass with Ug=0,6W/mqK and warm edge

Permeability to the air

Class 4

(min. 1 - max 4)

Resistance to water infiltration

Class 8A

(min. 1 - max 9)

Wind resistance

Class C3

(min. 1 - max 5)

Visio 130

Glass

As standard feature, **Visio 130** is equipped with argon filled temperate double glazing and warm edge. The standard glass cavity is 1" 3/16, with options for 1" 7/16" or 1" 23/32 sizes.*

Our vast catalogue of glasses includes several models: tinted glass, triple glass, acoustic glass or dual laminated glass and many more.

Furthermore we can install glasses with SHGC =<0.25.



* Glass cavity 1" 23/32 not available on Visio 130 Essential.

Handle - Toulon Model

Available in white, silver or matte black.
On request, we will install a double handle inside/out.

Locking/Thumb turn

On request, we will install a thumb turn lock and/or a cylinder with a unified key.

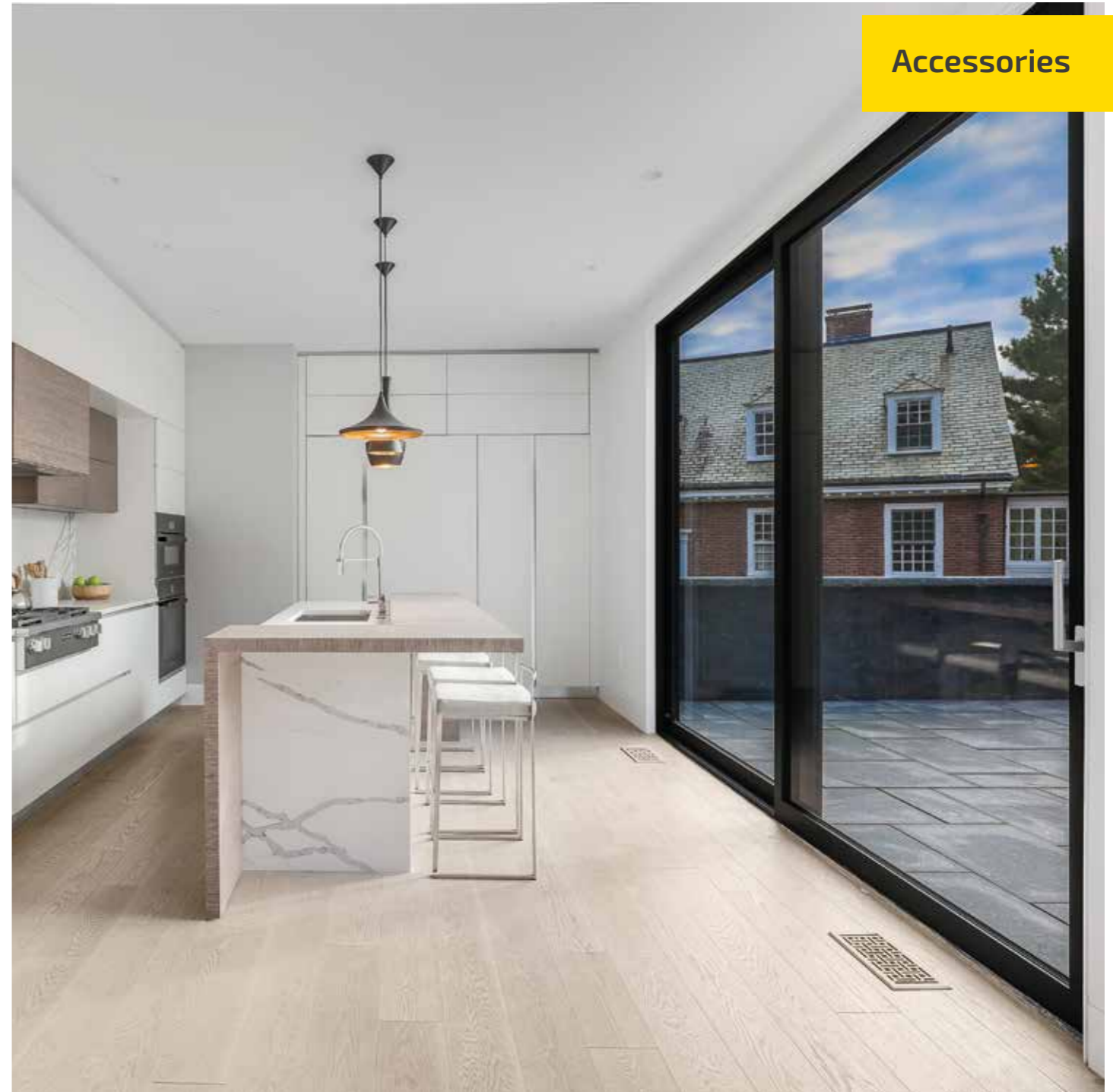

Below you can find the available typologies for **Visio 130** line.
On request pocketing solution available.

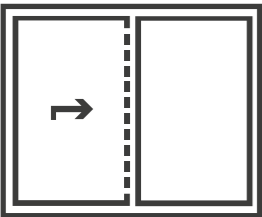

2-rail XO

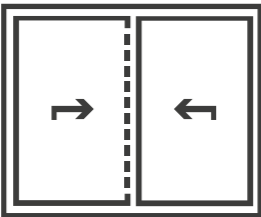

2-rail XX

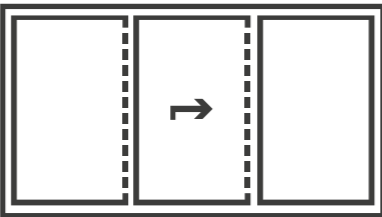

2-rail OXO

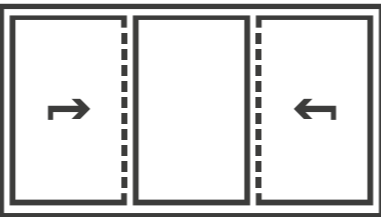

2-rail XOX

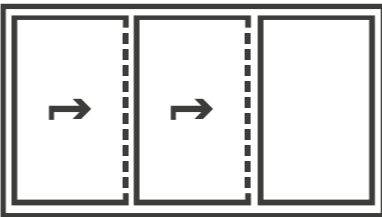

3-rail XXO

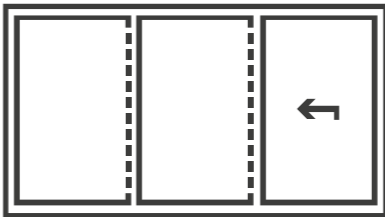

3-rail OOX

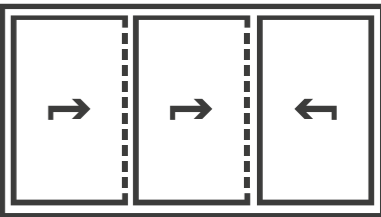

3-rail XXX

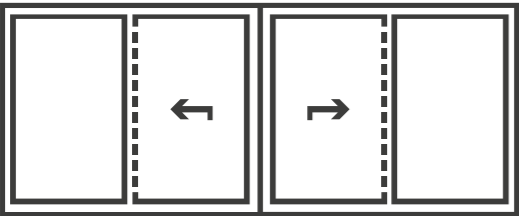

2-rail OXXO

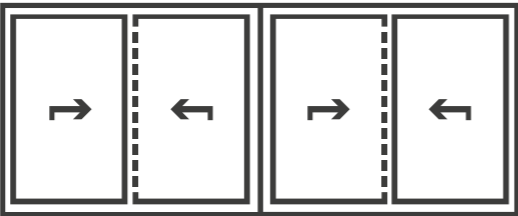

2-rail XXXX

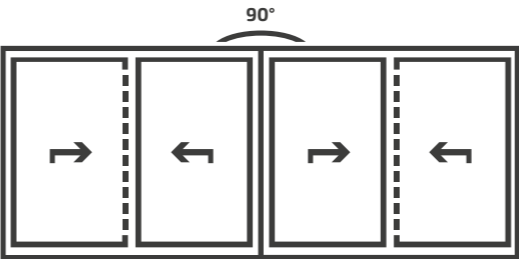

2-rail XXVXX corner



* HANDLE HOLE COVER

	XO – 2 rails	XX – 2 rails	OXO – 2 rails	XOX – 2 rails
Interlock	Slim (69mm) or Essential (50mm)	Slim (69mm) or Essential (50mm)	98mm	Slim (69mm) or Essential (50mm)
Low threshold	Yes	Yes	Yes	Yes
High threshold	Yes	Yes	Yes	Yes
Flush threshold	Yes	Yes	No	No
	Fix panel realized with handle hole cover*			

	OOX – 2 rails	XXXX – 2 rails	OXXO – 2 rails	XXX – 3 rails	XXO – 3 rails
	Slim (69mm) or Essential (50mm)	Slim (69mm) or Essential (50mm)	Slim (69mm) or Essential (50mm)	98mm	98mm
Yes	Yes	Yes	Yes	No	No
Yes	Yes	Yes	Yes	Yes	Yes
No	Yes	Yes	Yes	Yes	Yes
			Fix panel realized with handle hole cover*		Fix panel realized with handle hole cover*

Version		Visio 130 - 2 Rails and 3 Rails	Visio 130 Slim	Visio 130 Essential
Visible width/height	Frame	1" - 3/8	1" - 3/8	1" - 3/8
	Vent	3" - 11/16	3" - 11/16	3" - 11/16
	Threshold	0" - 25/32	0" - 25/32	0" - 25/32
	Meeting section	3" - 27/32	2" - 23/32	1" - 31/32
Overall system depth	Frame	5"15/32 2 rails - 8"9/32 3 rails	5" - 15/32	5" - 15/32
	Vent	2" - 5/16	2" - 5/16	2" - 5/16
Rebate height		0" - 31/32	0" - 31/32	0" - 31/32
Glass thickness		1" - 23/32	1" - 23/32	1" - 13/32
Glazing method		Dry glazing with EPDM or neutral silicone		
Thermal insulation		Fibreglass reinforced polyamide strips		

Visio 130 can be customized choosing among a huge selection of powder coating colors. All RAL colors are available, in glossy or matt finish. Moreover, it's possible to customize the window with special colors or anodized finishes.

Visio 130 Essential interlock

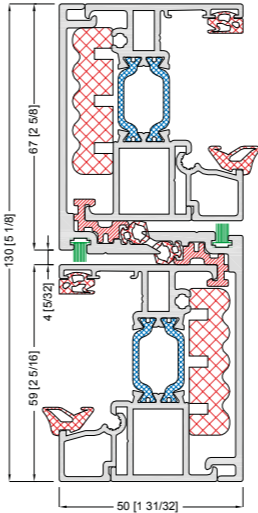

Visio 130 SLIM interlock

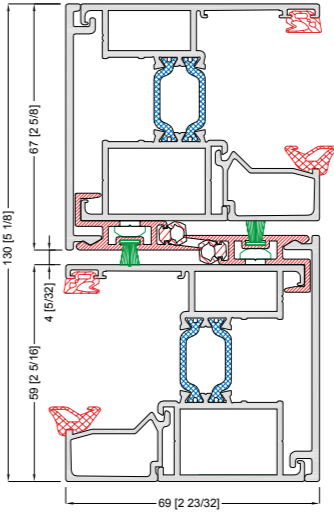

Visio 130 98 mm interlock
Mandatory in certain specific typologies.
See table above.

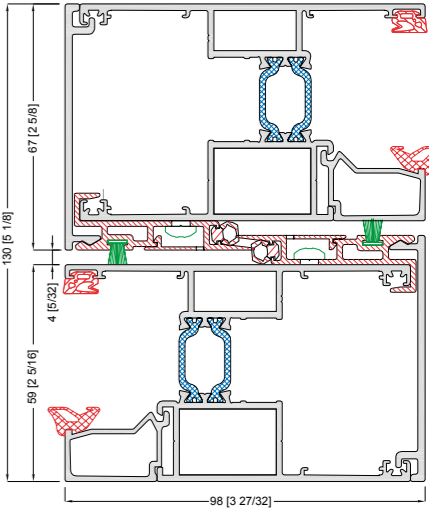

Visio 130

Low threshold section

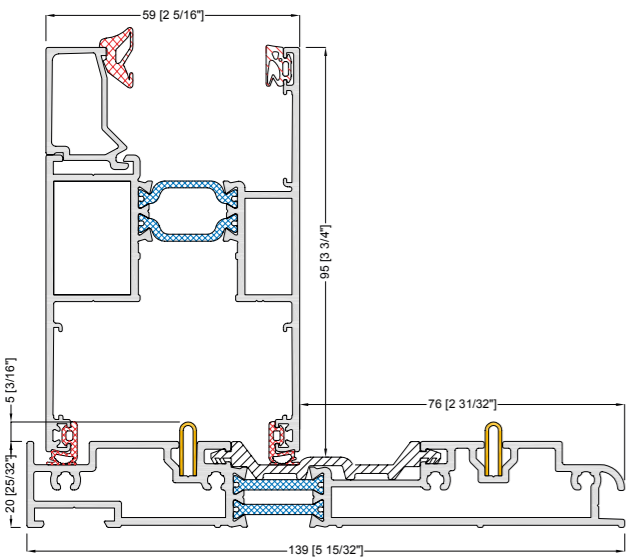

High threshold

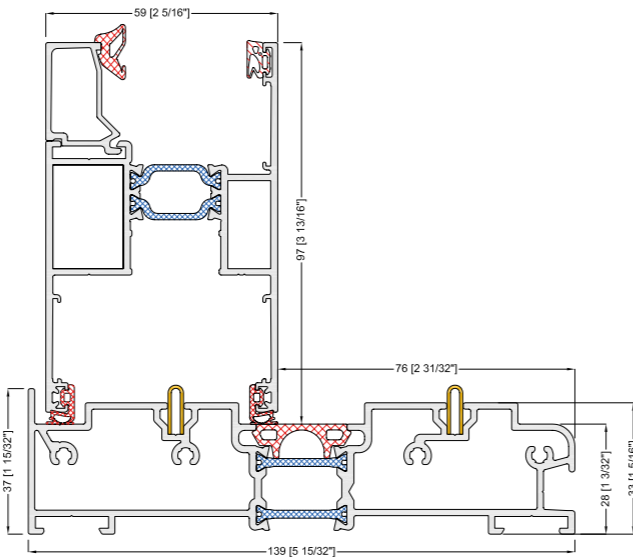

Threshold for Flush floor integration
Available in 2 or 3 rails

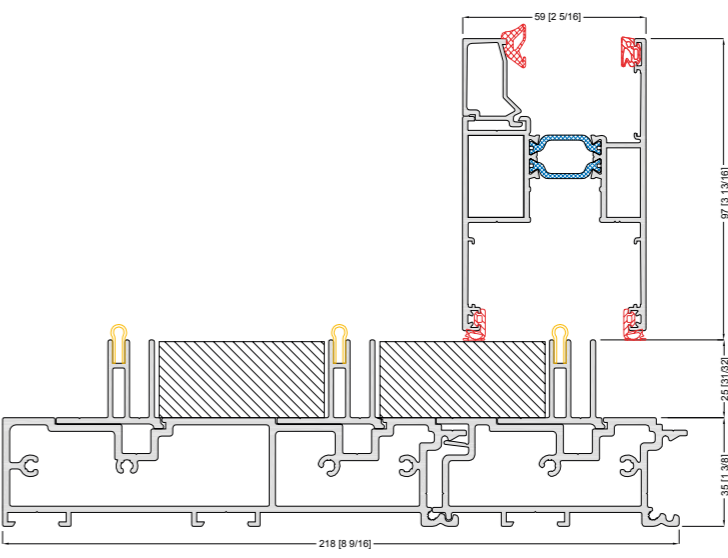

Visio 155

Visio 155 is a premium insulating lift-slide system, designed to create maximal glass areas, combined with increased comfort. This system achieves high insulation values, which makes the system suitable for low energy buildings.

The **Visio 155** lift-slide system allows one the opportunity to create an area using oversized glazed doors, with weights up to 400 kg. Unbelievably, it has an ultra-thin middle section of only 50mm (2").

To create space and continuity from indoors to outdoors, we offer a special corner solution.



2-rail high threshold

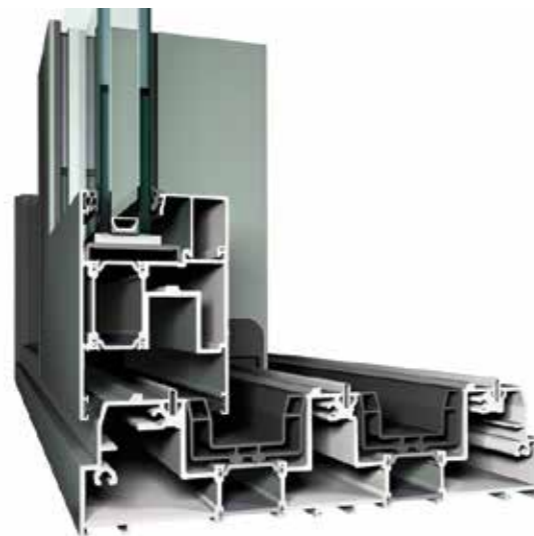

3-rail high threshold

The premium lift & slide system

Performance

Thermal insulation*

Uw up to 1,2 W/m²K

* calculated value on lift and slide two sash 3.000 mm W x 2.400 mm H and glass with Ug=0,6W/mqK and warm edge

Permeability to the air

Class 4

(min. 1 - max 4)

Resistance to water infiltration

Class E900 (900Pa)

Wind resistance

Class C4 (1600Pa)

(min. 1 - max 5)

Visio 155

Below you can find the available typologies for **Visio 155** line.

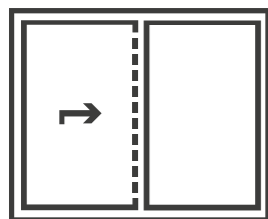

2-rail X0

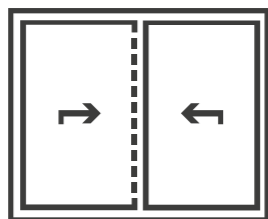

2-rail XX

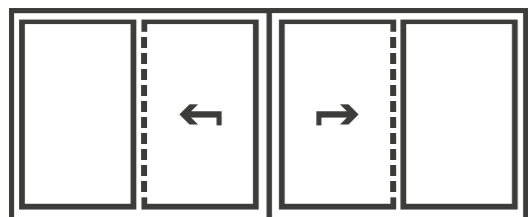

2-rail OXXO

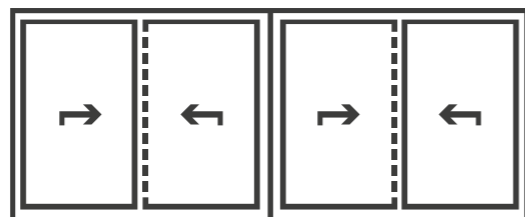

2-rail XXXX

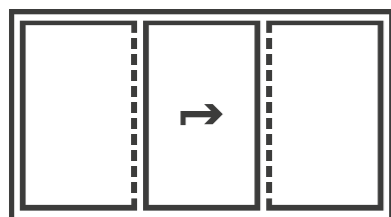

2-rail OXO

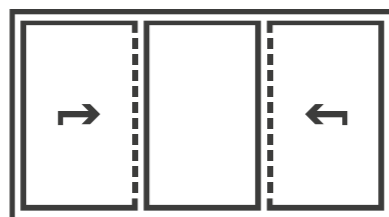

2-rail XOX

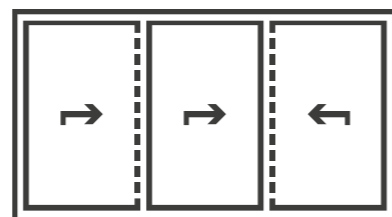

2-rail XXX

Available opening typologies _____

Available
opening typologies

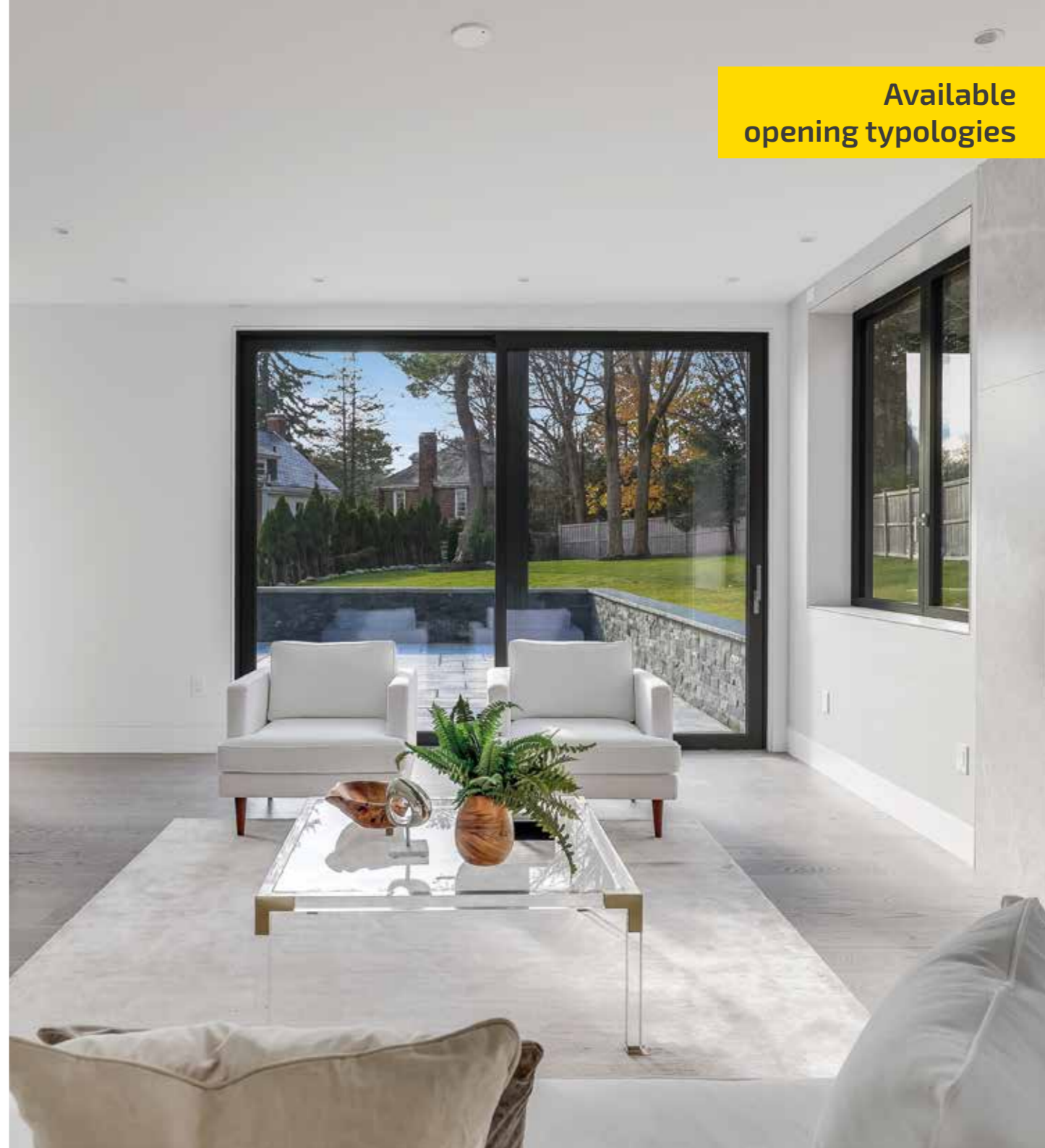

High threshold

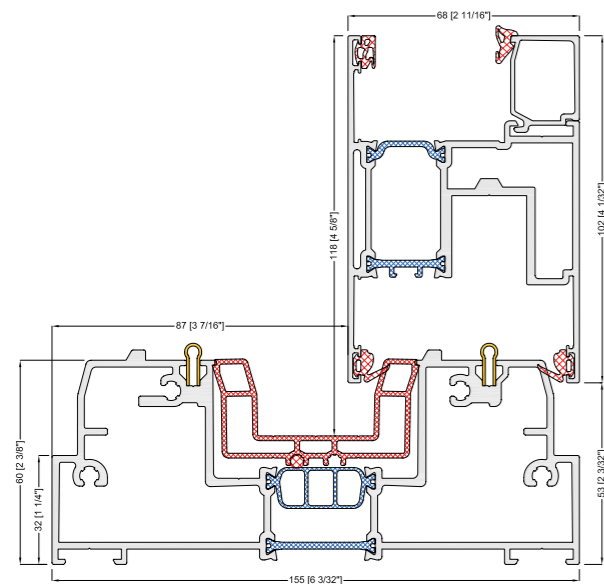

Threshold for flush floor integration

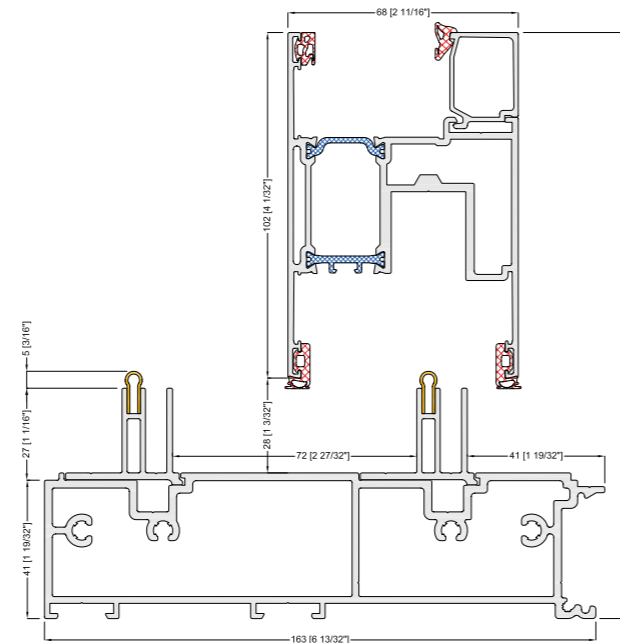

Standard interlock

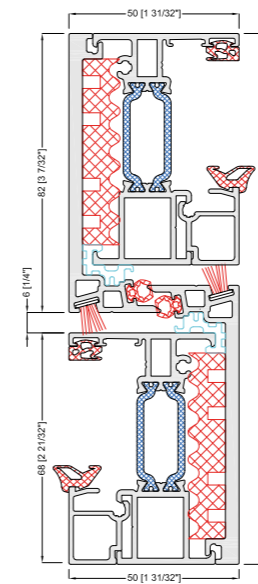

115 mm Interlock

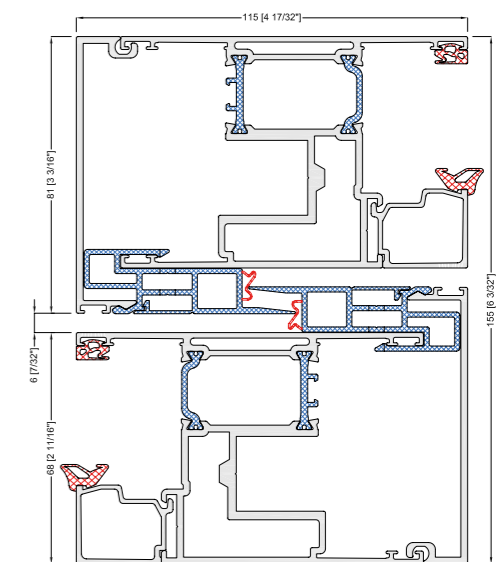

Threshold with water drainage

Technical sections

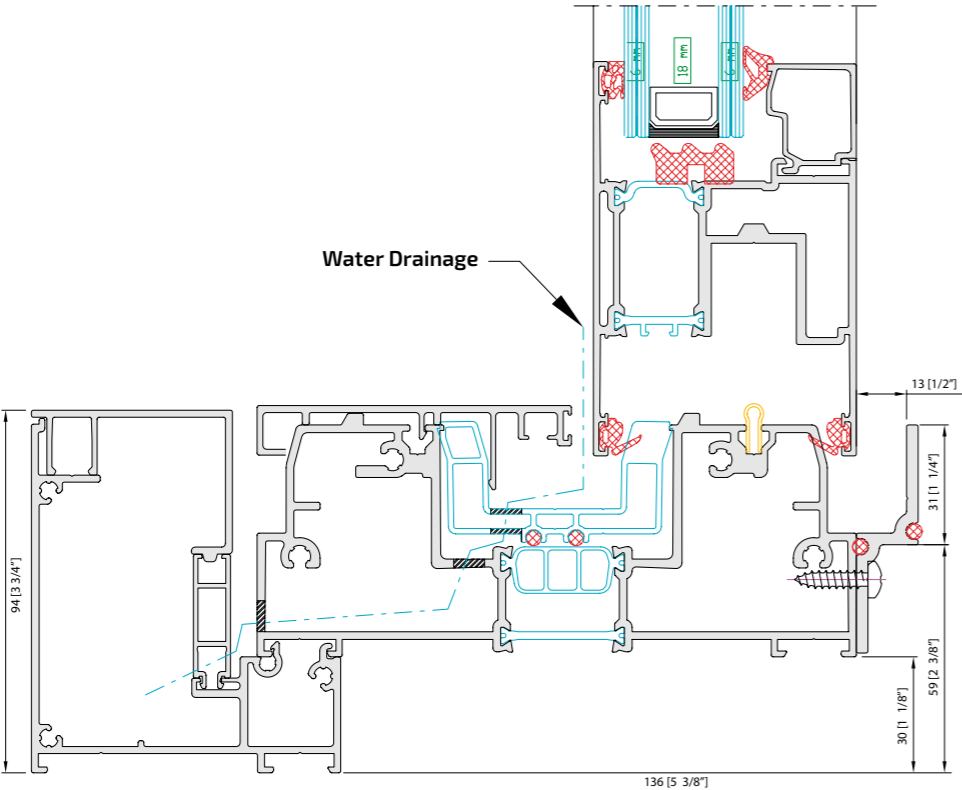

Visio 155

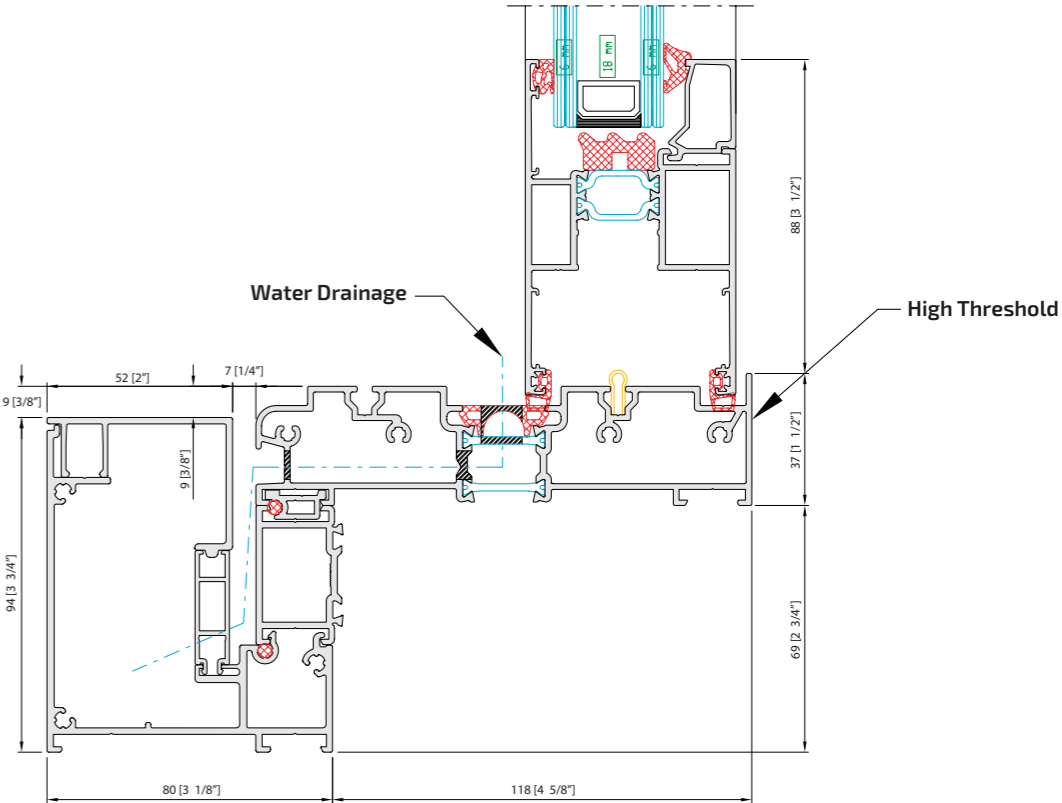

Visio 130

Visio 68

Visio 68 is a well insulated sliding system that combines elegance with performance. This unique sliding system is characterized by its slim profiles, allowing the integration of large windows and doors for maximum views. The integrated innovative technologies guarantee ultimate performances with regard to wind and water tightness and thermal insulation.

The **Visio 68** offers you the freedom to create well-lit, comfortable and secure contemporary living spaces. Available in 2 or 3 rails.

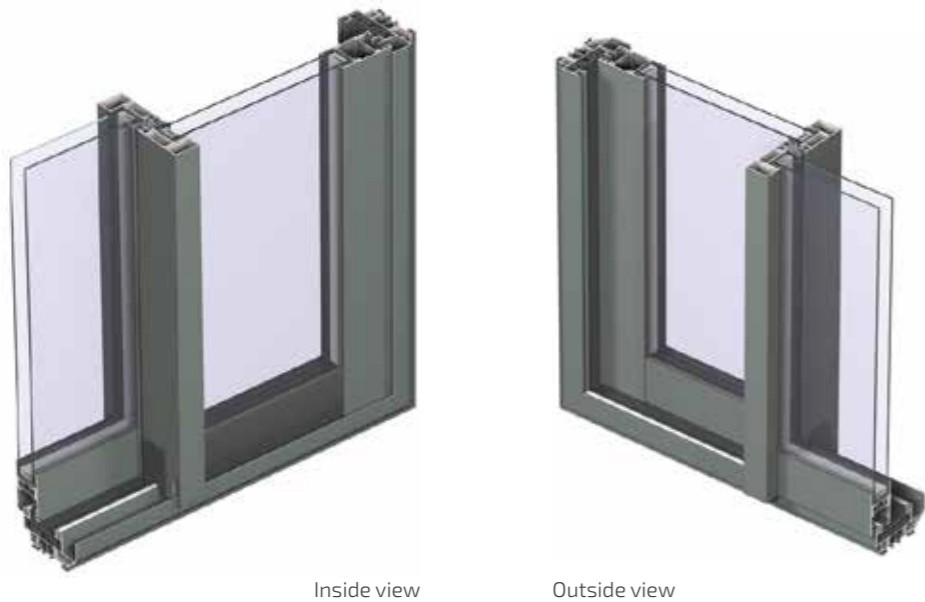

Simple and effective



Technical Charateristics

Variants		2 - rail	3 - rail
Visible width/height	Frame / Vent	4" 9/32	4" 9/32
	Meeting section	1" 11/32	1" 11/32
Overall system depth	Frame / Vent	2" 11/16	4" 7/8
	Meeting section	1" 21/32	1" 21/32
Maximal vent height		98" 7/16	
Maximal vent weight		160 kg	
Rebate height		23/32	
Glass thickness		1" 3/32 or 1"13/32	
Glazing method		with EPDM in accordance with the envelope principle	
Thermal insulation		1" 1/4 and 1"13/32 fibreglass reinforced polyamide strips	

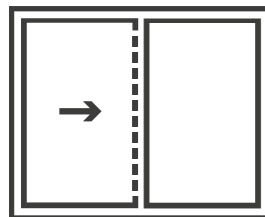

2-rail XO

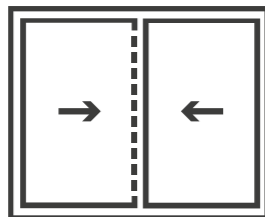

2-rail XX

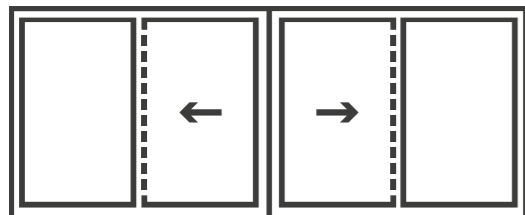

2-rail OXXO

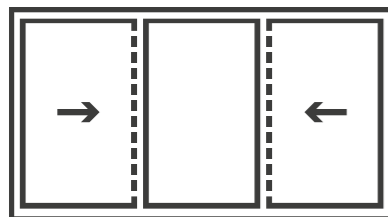

2-rail XOX

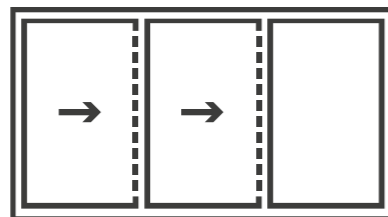

3-rail XXO

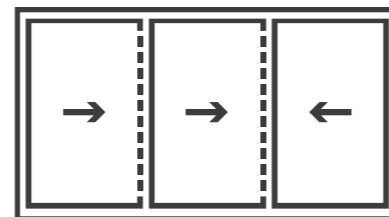

3-rail XXX



Visio 68



Colors available: white, silver and black matte.

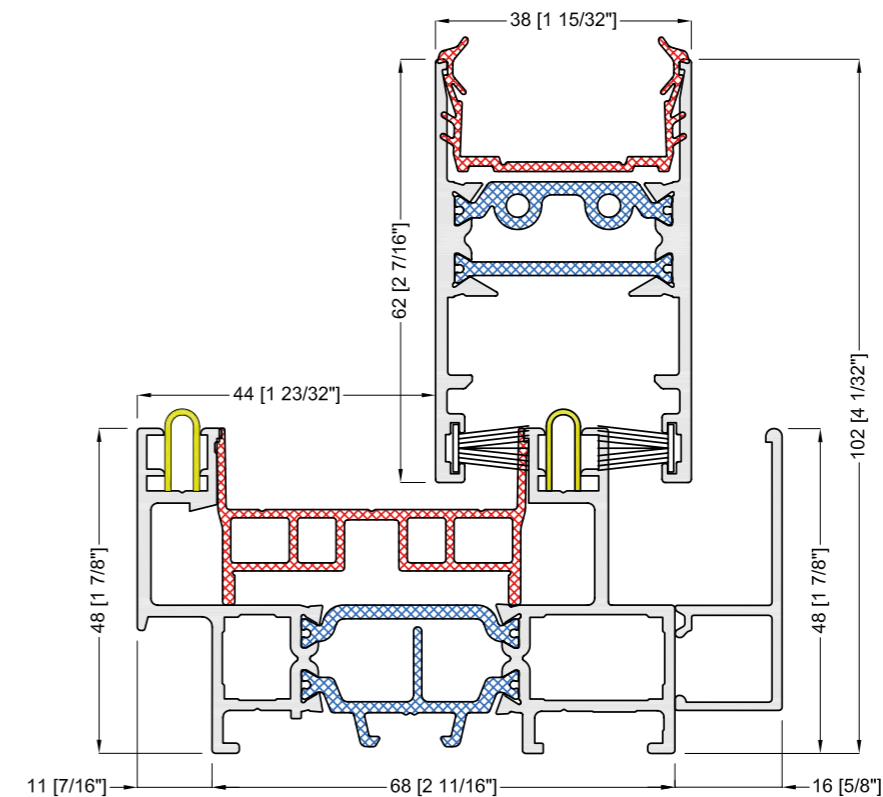
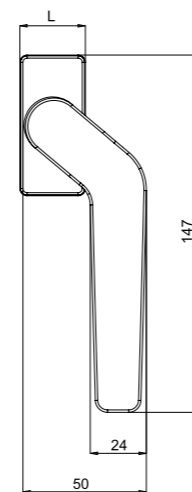
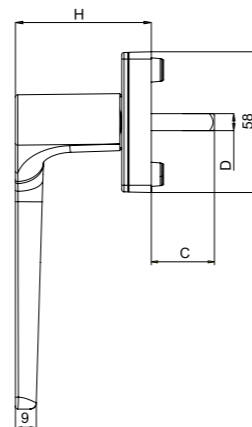

Threshold

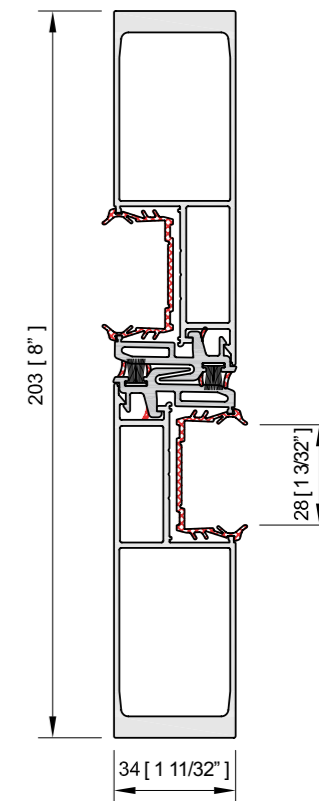

Interlock

Technical sections

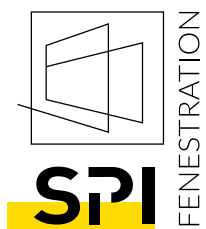

SPI Fenestration - USA
10845 Griffith Peak Drive #2
Las Vegas NV 89135
T: 702 418 3868
sales@spifenestration.com
www.spifenestration.com



SPI S.p.A. Factory
Zona Industriale
89843 Maierato Italy
T: +39 0963255814
www.spifinestre.it

